

Thurlow Park Road, Tulse Hill, SE21

2 bedroom flat to let

£415 Per Week

Furnished

Property Details

A spacious two double bedroom middle floor flat set in a fantastic location, in the heart of popular Tulse Hill. Thurlow Park Road is conveniently located just a short walk from the green open spaces of Brockwell Park, lauded as London's best outdoor space by locals with its amazing lido among its myriad attractions. The property comprises a spacious open-plan kitchen reception room, two good size double bedrooms, and a modern family size bathroom. Tulse Hill train station is within a two-minute stroll with trains to London Bridge and central London via Southern Rail and the Thames Link.

Features

- Two double bedrooms
- Open plan reception
- Bright and airy throughout
- Close to Transport links
- Close to Brockwell Park

Council tax band C EPC rating C (71)



Thurlow Park Road, Tulse Hill, SE21



2 Bed flat

Approx internal area:

685 sqft 64 sqm

While we do try our very best, floor plans are produced as a guide only and we take no responsibility for the precise accuracy with which any property is represented

Thurlow Park Road

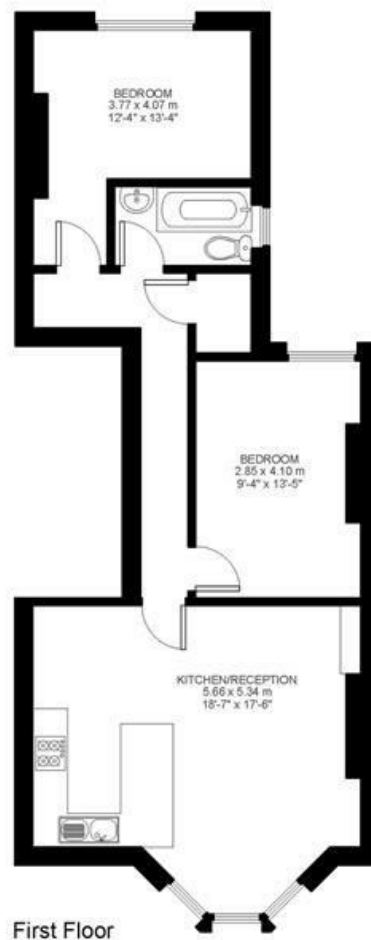

Thurlow Park Road, Tulse Hill, SE21

